

KNYSNA YACHT COMPANY

SAIL-AWAY SPECIFICATIONS

Let the world's finest boutique
yacht builders set yours in motion.



550

ANNEXURE A | Knysna 550 Voyage Ready - 4 Cabin

DIMENSIONS AND GENERAL DETAILS

Dimensions and General Details

Naval Architect	Du Toit Yacht Designs	
Length overall	16.55 m	54.28 ft
Length waterline	16.15 m	52.97 ft
Mast height above waterline	21.00 m	68.89 ft
Beam	8.88 m	29.12 ft
Beam Hull CL / Hull CL	6.60 m	21.65 ft
Hull Beam	2.27 m	7.45 ft
Freeboard (Bow)	1.91 m	6.27 ft
Freeboard (Stern)	1.75 m	5.73 ft
Hull Draft	0.64 m	2.10 ft
Draft	1.44 m	4.72 ft
Air Draft	23.87 m	78.33 ft
Bridgedeck Clearance	0.90 m	2.95 ft
Displacement (DWL)	15 406 kg	33 970 lbs
Sail Area Total	155.8 m ²	1677 ft ²
Jib	45.5 m ²	586.63 ft ²
Mainsail	110.3 m ²	1187 ft ²
Engines	2x 80 hp	
Water Capacity	1x 1000 lt	264 US Gal
Fuel Capacity	1x 1000 lt	264 US Gal
Construction	GRP Vacuum – bagged foam sandwich	

Hull, Deck and Bulkheads

- 1 x Vacuum bagged – hand laid 80 density PVC foam core, quadriaxial non – crimp fabric, NPG gel coat, vinyl ester resin though-out.

Rudders & Steering

- 2 x Balanced spade rudders, with reinforcement
- 2 x 316 Stainless steel stocks in Vesconite bushes
- 1 x Hydraulic bulkhead steering system
- 1 x Destroyer type stainless steel wheel (EDSON) 32 inch*

Engines

- 2 x 80 hp common rail Yanmar – diesel engines (Turbo) and sail drives SD 60, fresh water cooled*



Engine Installation

- 2 x Exhaust system
- 2 x Exhaust blowers
- 2 x Electronic Engine controls / Flybridge / Interior Nav Station
- Battery cables and connection
- 2 x Exhaust anti – siphon valves
- 2 x Propellers (Standard 3-blade fixed)*
- 2 x Engine beds and fittings
- 2 x Engine compartments (under aft bunks)
- 2 x Instrument panels*

Main sheet System - Harken

- 1 x Traveler track
- 1 x Traveler controls and tackle 3:1
- 1 x Single block & bracket
- 1 x Traveler car circulating torlon ball system
- 4 x Single blocks

Mast, Spars and Rigging - Sparcraft

- 1 x Aluminium anodized mast with fwd crossbeam and compression strut
- 2 x Chain plates with cap shrouds
- 1 x Mast Plate
- 1 x Harken batt-car system C

Fuel System

- 1 x Built in tank approximately 1000 litres (264 US gal)*
- 1 x Deck filler fitted on tank
- 2 x Fuel filter with water traps (Racor FG500)
- 11 x Stop cocks
- 1 x Tank inspection hatch
- 1 x Tank sender (Fuel gauge) Wema-type

ANNEXURE A

Water Tank

- 1 x Built in 1000 litres (264 US gal) - VE resin & fibreglass
- 1 x Deck filler fitted on tank
- 1 x Tank inspection hatch
- 1 x Tank sender (Water gauge) Wema-type

Windows / Sliding Door

Non – scratch 8.75mm grey anti – sun armour plated glass to large areas 6mm to balance, including 2 panel sliding door

Deck Fittings

- 2 x Stainless steel pulpits and seats
- 2 x Stainless steel pushpits
- 8 x 750 mm / 29.5 inches high double wire stanchions with guard wire*
- 6 x Large mooring cleats
- 4 x 2200mm stainless steel grabrails (coachroof and sugarscoops)
- 6 x 300mm stainless steel hand rails (2 x coachroof / 4 x interior)
- 3 x Winch handle pockets
- 1 x Swimming ladder (Port – side)
- 1 x Mast gooseneck
- 2 x Medium (260 mm) mooring cleats

Hatches and port lights

- 12 x Size 54 (cabins, saloon, heads, forepeaks)
- 2 x Size 30 low profile (saloon facing fwd at mast)
- 8 x Fixed glass portlights (hulls)
- 4 x Fixed glass slanted portlights (hulls)
- 2 x Size 47 (MAG Vetus escape hatches in heads below trampoline)
- 2 x Size 4 port lights (aft cabins above headboard)
- 2 x Custom large hatches above engine compartments
- 12 x Oceanair blinds to size 54 hatches



Winches - Harken aluminium self-tailing

- 2 x 60 Self tailing electric winches (Chrome)*
- 4 x 50 Self tailing winches (Chrome)*
- 1 x 30 Self tailing winch (Chrome)*
- 3 x Harken lock in handles
- 1 x Anchor windlass electric Quick 1500w

Plumbing

- 2 x Fresh water pressure pumps with accumulator tanks
- 2 x Electric bilge pumps
- 2 x Manual bilge pumps
- 1 x 50L Calorifier 220V AC with element and thermostat
- 2 x Grey water pumps
- 1 x Fresh water shower at transom (hot / cold)
- 1 x Deck wash with inlet and outlet

- 1 x Watermaker Modular Schenker 100 lt per hour
- 1 x Samsung 9 kg top loader washing machine

Running Rigging

- 1 x Main sheet with tackle
- 2 x Genoa sheet
- 4 x Halyards, main, genoa, storm jib

Genoa system - Harken

- 1 x Self tacking jib (track system)
- 2 x Foot blocks & jammer for roller furler
- 2 x Genoa tri-roller cars
- 1 x Electrical furling system for the genoa sail (NDE2/C430 roller furler)

ANNEXURE A

Painting

- Vinyl graphics (yacht name, boot stripe and deck stripe)
- Interior paint x 2 coats*
- Polycell ripple finish on large areas
- Anti - fouling 5 coats Gel Shield Primer and 2 coats Ablative (anti fouling)

Electrical

- 1 x Marine distribution boards DC and AC
- Navigation light package (bi-colour navlight on bow, tri-colour navlight on mast, steaming light, stern light, anchor light & decklight.)
- 12 x 220V AC outlets where applicable
- 2 x Speakers – saloon
- 4 x Waterproof speakers – cockpit
- 4 x Waterproof speakers – flybridge
- Appropriately sized tinned multicore wire in conduits
- 1 x Dimmers to saloon, cockpit and flybridge
- 4 x 12V plug points (external and internal)
- 1 x 12V entertainment system (Fusion-type AV755)
- 1 x 220V Flat screen TV – 43 inch
- 1 x Battery management system (Mastervolt Easyview 5 touchscreen monitor)
- 2 x Inverter (Mastervolt mass sine ultra 24 / 4000)
- 1 x Shore power charging unit (Mastervolt Chargemaster 24 / 100-3)
- 1 x 24000 BTU Aircon in saloon
- 4 x 12000 BTU Air conditioners in cabins
- 1 x Fisher Panda DC generator 6.4Kw
- 5 x Sirocco gimbal cabin fans (galley , cabins, other)
- 2 x Underwater lights

Batteries

- 3 x Engine and generator 12V starter batteries
- 4 x Mastervolt 24V 180 amp hour lithium Ion batteries*

Gas

- 1 x Electonic solenoid valve
- 1 x Regulator

- 2 x 9kg composit gas cylinder*
- 1 x Gas snuffer (electronic)

Cockpit

- 1 x Burmese teak table
- 1 x Upholstered seating and backrests
- 4 x Underseat lockers
- 1 x Integrated coach roof with 2 x sliding hatches
- 1 x Ice Maker
- 1 x Weber Gas BBQ Q2200 on stainless steel railing
- 1 x Synthetic teak decking under coach roof*
- 1 x Stainless steel - bait board with Corian top
- 3 x Wooden folding chairs for cockpit dining area with Knysna Yacht Company logo
- 1 x Roll down weather blinds

Navigation - Garmin instrumentation

- 2 x Garmin GMI 20*
- 1 x Garmin reactor 40 autopilot package
- 1 x Autopilot hydraulic pump
- 1 x Garmin gwind package
- 2 x Airmar P319 (50/200 kHz) depth transducer*
- 1 x GPS 19x NMEA 2000 antenna
- 1 x Garmin VHF315i radio and antenna*
- 1 x Garmin 16" chart plotter gpsmap 8416*
- 1 x Garmin GMR 18xHD radar*
- 1 x Garmin AIS 800
- 1 x AIS Antenna GA38 GPS \ glonass

Anchorage and Mooring

- 1 x 55kg Rocna anchor, 100m (10mm) chain, 10m (18mm) anchor warp*
- 1 x Main anchor bridle 16 meters
- 6 x Mooring warps 16mm – (4 x 12m, 2 x 6m)
- 1 x 20kg Dan forth anchor, 10m (8mm) Chain, 30m (18mm) anchor warp
- 6 x Cylindrical fenders std size*
- 1 x Windlass (Quick) electronic chain counter (remote fixed at helm)

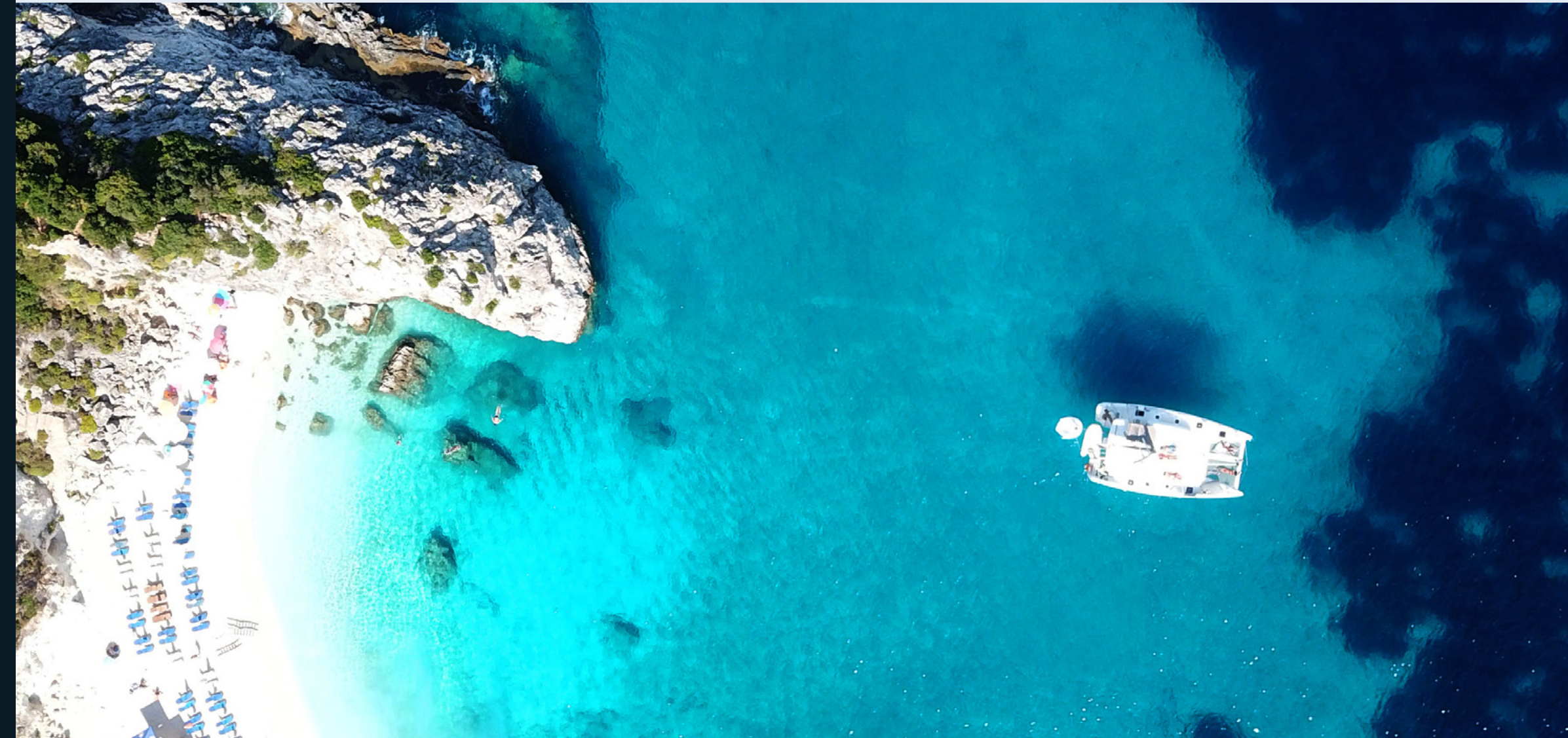

Cabins - Depending on Layout

- 4 x Double cabins (en-suite) each with:
 - Vanity and seat or step (FWD cabin / master cabin)
 - Cupboards and hanging / packing space
 - HPL / vinyl flooring
 - Standard high density foam mattresses and headboards

Heads - Depending on Lay-out

- 4 x Heads fitted with:
 - 1 x Shower
 - 1 x Acrylic basins Corian or similar
 - 1 x Vanity cabinet with mirror*
 - 1 x Standard toilets (Electrical fresh water flush)*
 - 1 x Towel ring
 - 2 x Towel hooks

ANNEXURE A

Flybridge

- 1 x Burmese teak table
- 1 x Upholstered seating and backrests
- 2 x Underseat lockers
- 1 x Std 2 person helm seat
- 1 x Bar fridge
- 1 x Roll down weather blinds
- 1 x Fixed full size bimini hardtop
- 1 x Small prep bowl with cold water supply
- 1 x Synthetic teak decking on flybridge floor

Galley

- 1 x Floors – Vinyl or HPL
- 1 x 4 plate gas hob*
- 1 x Gas oven (Eurogas or similar) 600mm
- 1 x 200L Isotherm combo 12 volt fridge / freezer
- 1 x 90L Isotherm 12 volt deep freeze (clean touch)
- 1 x Double bowl sink
- 1 x Microwave oven 32lt*

Saloon

- 1 x Saloon dining table*
- 1 x Upholstered seats surrounding large seating dining area - can accommodate 6 - 8 people
- 1 x Bar Counter with TV unit
- 1 x Floors HPL / Vinyl*
- 2 x Barka Table Pedestals (Manual) to convert saloon table to daybed
- 1 x Mattress to saloon daybed (upholstered to match)
- 2 x Bar stools for saloon area (upholstered to match)

Internal Joinery & Finishes

Foam core with high pressure laminate (HPL) finished with solid wood trims and edges
 (4 Cabins, 4 Head doors, locker doors depending on lay-out)
 Allowance for fixed upholstered furniture equivalent to \$7500*

Tender & Outboard

- 1 x Infanta 3.6 SR tender boat*
- 1 x Mercury 4 Stroke EFI F20MH Outboard Motor*

*These items can be upgraded. Please refer to our list of optional extra's and upgrades for details.

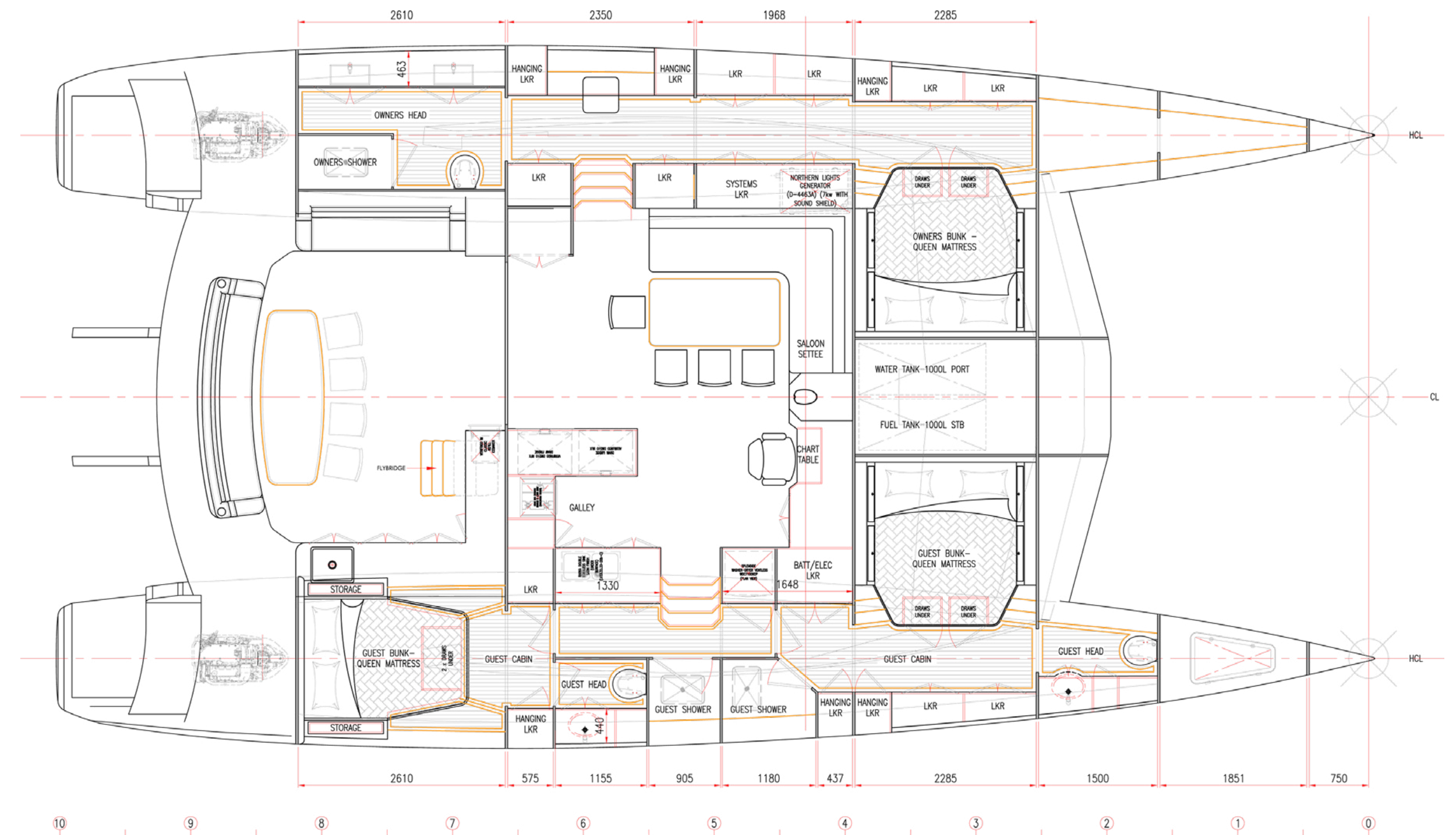

Sails

- 1 x Main 110.3 m² / 1187 ft² cross cut, laminated fabric, fully battened 800 sq ft. cross cut, Dacron fabric, fully battened with lazy jacks. Branded with Knysna Yacht Company logo*
- 1 x Furling Genoa 45 m² / 586.63 ft² radial cut, Dacron fabric complete with UV strip and Knysna Yacht Company logo
- 1 x Screecher sail package with top down furler (Karver) and rigging

Safety Package

- 5 x Battery operated smoke & carbon monoxide detectors
- 1 x Complete safety package as per SAMSA Cat A including 8 man life raft and EPIRB

Commissioning - Sea trials and commissioning two weeks in Knysna, South Africa.

Excludes any customization and changes to standard layout

Package includes single colour choice for finishes such as floors, countertops, cladding and fabrics

Please note: Specifications subject to change without prior notice.

For more information about our yachts, or any other queries, please contact us at:

Email: enquiries@knysnayachtco.com

Phone: +27(0) 44 382 2847

Mobile: +27 (0) 82 781 2829

Website: www.knysnayachtco.com

KNYSNA YACHT COMPANY

CONTACT US 



550